

# Proposed Site Map

## MULFORD QUARRY ASPHALT PLANT

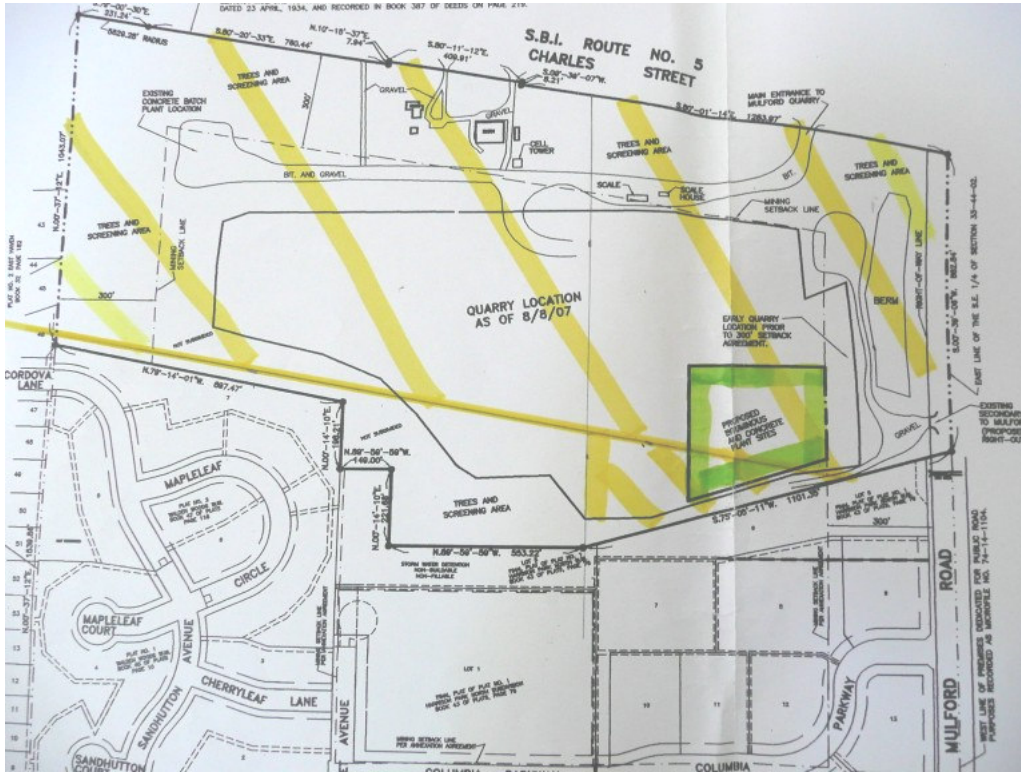

THIS IS THE SITE MAP PROVIDED WHICH SHOWS THE PROPOSED LOCATION FOR THE MULFORD QUARRY ASPHALT PLANT - OUTLINED IN GREEN

THE YELLOW STRIPED AREA REPRESENTS AN AREA THAT IS 1,000 FEET FROM CHARLES STREET ON THE NORTH AND 1,000 FEET FROM MULFORD ROAD ON THE EAST. ZONING REGULATIONS STATE AN ASPHALT PLANT SHOULD NOT BE CLOSER THAN 1,000 FROM THE NEAREST RESIDENTIAL AREA.

NOTE, THAT THE NEW STREETS IN THE LOWER LEFT CORNER REPRESENT THE WALDEN WOODS CONDOMINIUM COMPLEX.

IN OTHER WORDS, THERE IS NOT ANYWHERE IN THE MULFORD QUARRY WHERE THE ASPHALT COULD BE PLACED WITHOUT SOME KIND OF SPECIAL USE PERMIT FROM THE CITY.